

Coaxial Adapter Series SSMA/SMA

Features:

- Low VSWR

Applications:

- Wireless
- Transmitter
- Laboratory Test
- Radar

Electrical

Frequency: DC~26.5GHz
 VSWR: 1.3 max.
 Insertion Loss: 0.3dB max.
 Impedance: 50Ω

Environmental

Temperature: -55~+85 °C

Mechanical

RF Connectors: SSMA, SMA
 Mating Life Cycle: 500 cycles
 Outer Conductor: Passivated Stainless Steel
 Dielectric: PEI
 Inner Conductor: Gold Plated Beryllium Copper

Outline Drawings

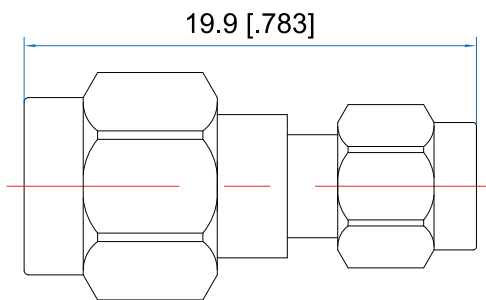

Outline A

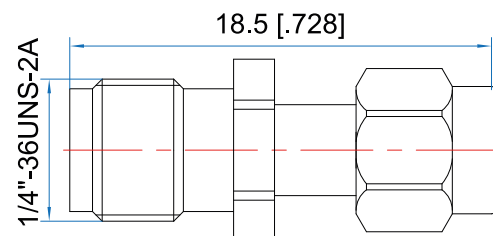

Outline B

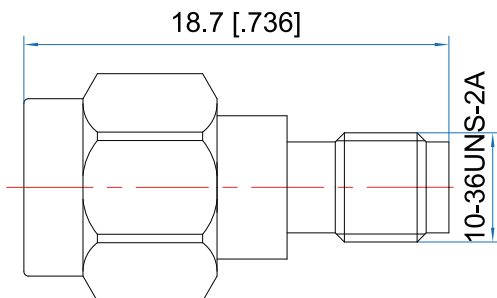

Outline C

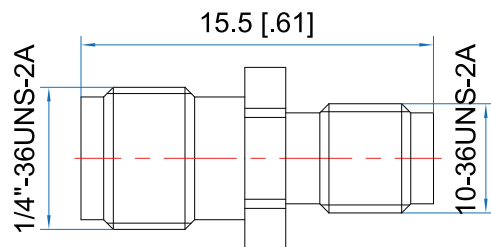

Outline D

Unit: mm [in]

Tolerance: ±0.2mm [±0.008in]

Interface:

RFC26-SSm-Sm: SSMA(m) to SMA(m), Outline A

RFC26-SSm-Sf: SSMA(m) to SMA(f), Outline B

RFC26-SSf-Sm: SSMA(f) to SMA(m), Outline C

RFC26-SSf-Sf: SSMA(f) to SMA(f), Outline D