

Coaxial Adapter Series SMA

Features:

- Low VSWR

Applications:

- Wireless
- Transmitter
- Laboratory Test
- Radar

Electrical

Frequency: DC~26.5GHz
DC~18GHz (right angle)
VSWR: 1.15 typ. 1.2 max.
Impedance: 50Ω

Environmental

Temperature: -60~+165 °C

Outline Drawings

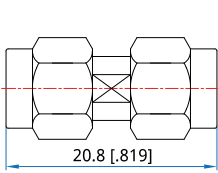

Outline A

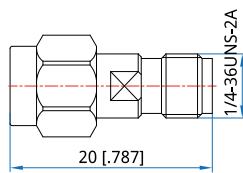

Outline B

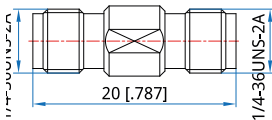

Outline C

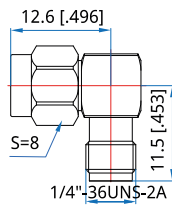

Outline D

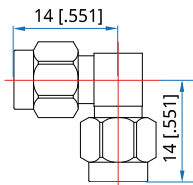

Outline E

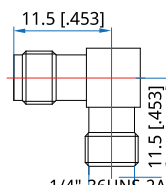

Outline F

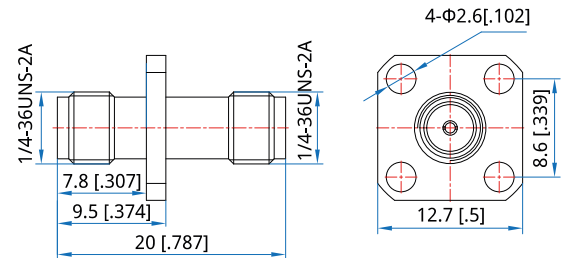

Outline G

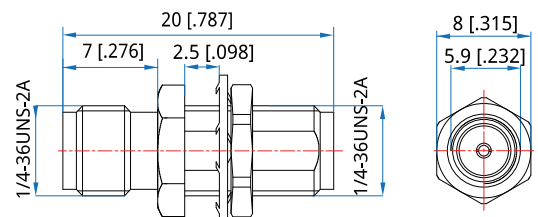

Outline H

Mechanical

RF Connectors: 2.92mm
Mating Life Cycle: 500 cycles
Outer Conductor: SUS303 Stainless Steel
Dielectric: PEI
Inner Conductor: Gold Plated Beryllium Copper

- RFC26-Sm-Sm:** SMA(m)/SMA(m), Outline A
- RFC26-Sm-Sf:** SMA(m)/SMA(f), Outline B
- RFC26-Sf-Sf:** SMA(f)/SMA(f), Outline C
- RFC26-Sm-Sf(RA):** SMA(m)/SMA(f) right angle, Outline D
- RFC26-Sm-Sm(RA):** SMA(m)/SMA(m) right angle, Outline E
- RFC26-Sf-Sf(RA):** SMA(f)/SMA(f) right angle, Outline F
- RFC26-Sf-Sf(FL):** SMA(f)/SMA(f) flange mount, Outline G
- RFC26-Sf-Sf(BH):** SMA(f)/SMA(f) bulkhead, Outline H

Unit: mm [in]
Tolerance: ±0.2mm [±0.008in]