

Coaxial Adapter Series SC

Features:

- Low VSWR

Applications:

- Wireless
- Transmitter
- Laboratory Test
- Radar

Electrical

Frequency: DC~6GHz
 VSWR: 1.25 max.
 Impedance: 50Ω

Environmental

Temperature: -55~+85 °C

Mechanical

RF Connectors: SC

Mating Life Cycle: 500 cycles

Outer Conductor: Nickel Plated Brass or
 SUS303 Stainless Steel

Dielectric: PTFE

Inner Conductor: Gold Plated Tin-phosphor
 Bronze

Outline Drawings

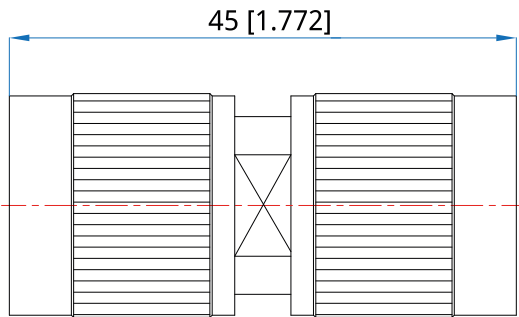

Outline A

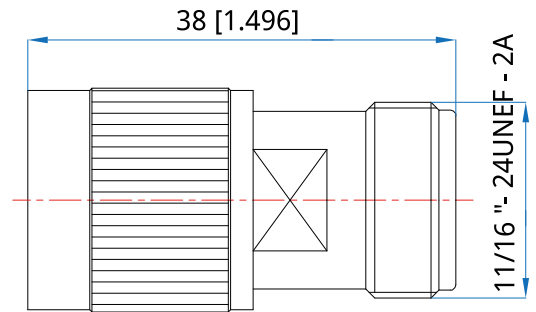

Outline B

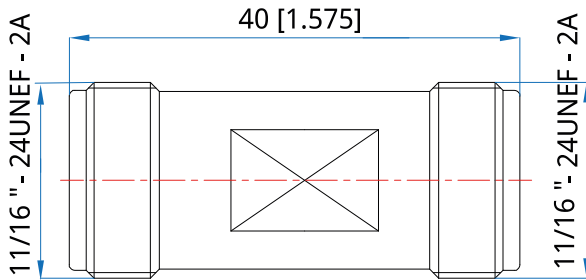

Outline C

Unit: mm [in]

Tolerance: ±0.2mm [±0.008in]

Interface:

RFC6-SCm-SCm: SC(m)/SC(m), Outline A

RFC6-SCm-SCf: SC(m)/SC(f), Outline B

RFC6-SCf-SCf: SC(f)/SC(f), Outline C