

**Coaxial Adapter Series SC/7/16(DIN)**

**Features:**

- Low VSWR

**Applications:**

- Wireless
- Transmitter
- Laboratory Test
- Radar

**Electrical**

Frequency: DC~6GHz  
 VSWR: 1.25 max.  
 Impedance: 50Ω

**Environmental**

Temperature: -55~+85 °C

**Mechanical**

Length: 45.3mm, 1.783in  
 RF Connectors: SC, 7/16 DIN  
 Mating Life Cycle: 500 cycles

Outer Conductor: Nickel Plated Brass or  
 SUS303 Stainless Steel

Dielectric: PTFE

Inner Conductor: Gold Plated Tin-phosphor  
 Bronze

**Outline Drawings**

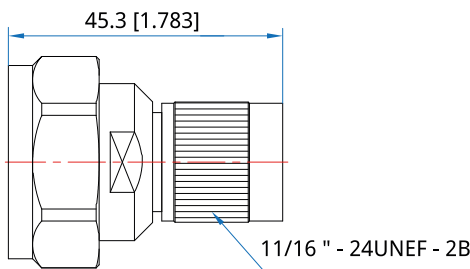

Outline A

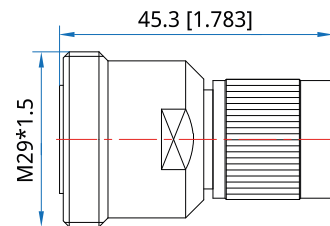

Outline B

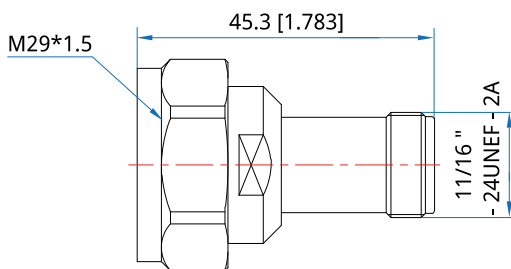

Outline C

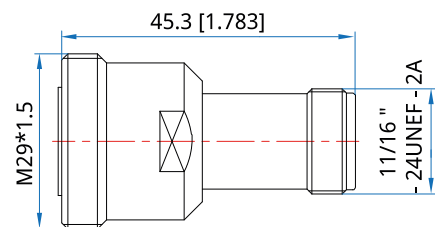

Outline D

Unit: mm [in]

Tolerance: ±0.2mm [±0.008in]

**Interface:**

**RFC6 SCm-DINm:** SC(m) to 7/16(m), Outline A

**RFC6 SCm-DINf:** SC(m) to 7/16(f), Outline B

**RFC6 SCf-DINm:** SC(f) to 7/16(m), Outline C

**RFC6 SCf-DINf:** SC(f) to 7/16(f), Outline D