

Coaxial Adapter Series 2.4 mm/SMP

Features:

- Low VSWR

Applications:

- Wireless
- Transmitter
- Laboratory Test
- Radar

Electrical

Frequency: DC~40GHz
 VSWR: 1.5 max.
 Impedance: 50Ω

Environmental

Temperature: -50~+85 °C

Mechanical

RF Connectors: 2.4mm, SMP
 Mating Life Cycle: 500 cycles
 Outer Conductor: Passivated Stainless Steel
 Dielectric: PEI
 Inner Conductor: Gold Plated Beryllium Copper

Outline Drawings

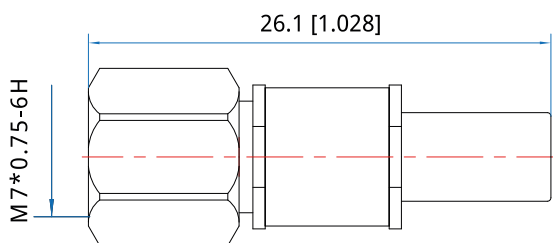

Outline A

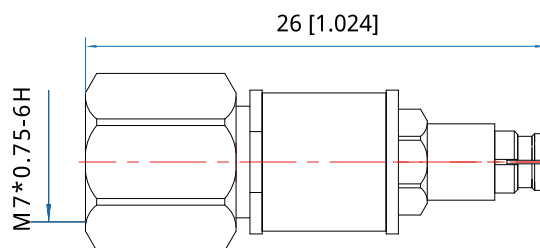

Outline B

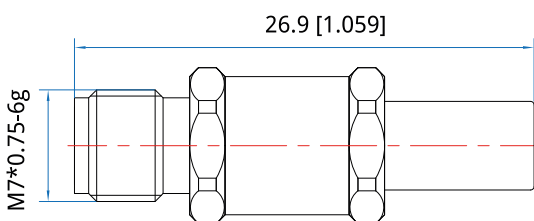

Outline C

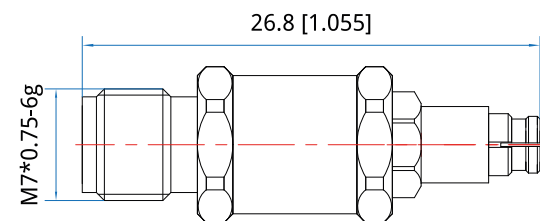

Outline D

Unit: mm [in]

Tolerance: ±0.2mm [±0.008in]

Interface:

RFC40-24m-Mm: 2.4mm(m) to SMP(m), Outline A

RFC40-24m-Mf: 2.4mm(m) to SMP(f), Outline B

RFC40-24f-Mm: 2.4mm(f) to SMP(m), Outline C

RFC40-24f-Mf: 2.4mm(f) to SMP(f), Outline D