

RFC-ADT-40

COAXIAL ADAPTERS

Coaxial Adapter Series 2.92 mm

Features:

- Low VSWR

Applications:

- Wireless
- Transmitter
- Laboratory Test
- Radar

Electrical

Frequency: DC~40GHz

VSWR: 1.15 max.

1.25 max. for right angle

Impedance: 50Ω

Environmental

Temperature: -60~+165 °C

Mechanical

RF Connectors: 2.92mm

Mating Life Cycle: 500 cycles

Outer Conductor: SUS303 Stainless Steel

Dielectric: PEI

Inner Conductor: Gold Plated Beryllium Copper

Outline Drawings

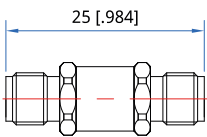

Outline A

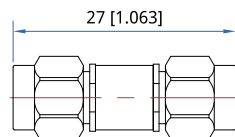

Outline B

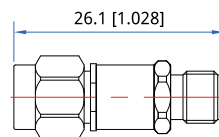

Outline C

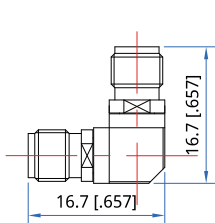

Outline D

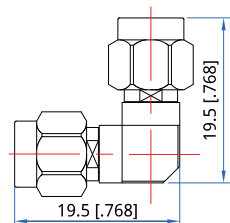

Outline E

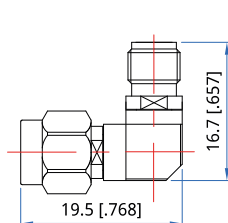

Outline F

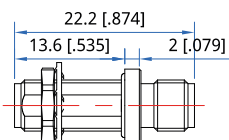

Outline G

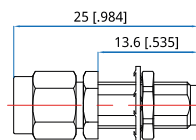

Outline H

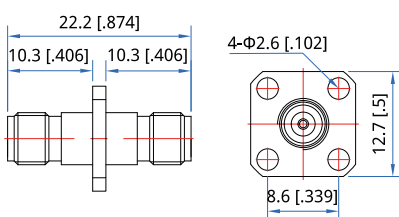

Outline I

Unit: mm [in]

Tolerance: ±0.2mm [±0.008in]

RFC40-29f-29f: 2.92mm(f)/2.92mm(f), Outline A

RFC40-29m-29m: 2.92mm(m)/2.92mm(m), Outline B

RFC40-29m-29f: 2.92mm(m)/2.92mm(f), Outline C

RFC40-29f-29f(RA): 2.92mm(f)/2.92mm(f) right angle, Outline D

RFC40-29m-29m(RA): 2.92mm(m)/2.92mm(m) right angle, Outline E

RFC40-29m-29f(RA): 2.92mm(m)/2.92mm(f) right angle, Outline F

RFC40-29f-29f(BH): 2.92mm(f)/2.92mm(f) bulkhead, Outline G

RFC40-29m-29f(BH): 2.92mm(m)/2.92mm(f) bulkhead, Outline H

RFC40-29f-29f(FL): 2.92mm(f)/2.92mm(f) flange mount, Outline I